

Home Wiring Guide



Document No: TG-002

Issue Date: 14/01/2009

Version: 2.0

Document Control Sheet

Record of Issue

Issue	Date	Description
A	16-Nov-08	First draft document issued for discussion
1.0	14-Jan-08	
2.0	20-Mar-09	Template Change. General Updated

Acceptance and Approval

Issue	Name	Position	Signature	Date
A	S. Davies	GM, Operations		16-Nov-08
1.0	S. Davies	GM, Operations		14-Jan-08
2.0	S. Davies	GM, Operations		20-Mar-09

In the event of any enquiries with respect to this document, please contact:

Name	Position	Phone	Email
S. Davies	GM, Operations	-	sdavies@opticomm.net.au

Copyright Statement

Copyright of this material resides with Opticomm Co Pty Ltd. Apart from any fair dealing for the purposes of private study, research, criticism or review, as permitted under the Copyright Act 1968, no part may be reproduced or reused for any purposes whatever without prior written permission of the owner.

1.0 PURPOSE

The aim of this document is to outline what is required for homeowners and their builders, or developers to connect to telecommunication networks based on Fibre to the Home (FTTH) technology.

2.0 SCOPE

This document extends to detached or semi-detached buildings that are being built for residential or small business use. It covers requirements of connection from the telecommunications pit to the Home Distribution Unit.

3.0 THINGS YOU SHOULD KNOW ABOUT A FIBRE COMMUNITY

Modern technology has brought many changes to the way we live, specifically in communications where many new services are being introduced that require high-speed delivery infrastructure. New Digital Telephone, Ultra-High Speed Internet and Television Services (including pay and free to air) offer greatly enhanced performance when compared to older technology. To accommodate these changes, residential developments must move forward with technology and provide infrastructure that will have the capacity for not only today but also for future technological advancements.

In standard residential areas, the incumbent carrier meets the basic communication needs of the community. At OptiComm, our commitment is about being at the forefront of the education and broadband revolution, and as such we provide advanced fibre optic communication infrastructure as a replacement for the traditional copper network.

3.1 Services

Opticomm's fibre optic based communication network will provide a range of services, including reticulation of the analogue and digital free to air television signals, Pay TV, Ultra-High-Speed Internet, and a Standard Telephone Service. Additional services, such as Community Intranet, security monitoring, gate control, and new entertainment services such as IPTV and Video-on-Demand, are all possibilities with this latest technology. These may be introduced in the future.

3.2 Connection

A fibre optic enabled community allows for you to connect to the network that runs past your property. A fibre optic lead in cable connects to a device on the external wall of your home. This is called a Network Termination Device (NTD) and it is where the optical signal (light) is converted to an electrical signal and retransmitted on twisted pair and coaxial cable to your Home Distribution Unit (HDU).

4.0 HOME WIRING GUIDELINES

A structured cabling system in today's home is important to take full advantage of modern telecommunications systems. All cabling shall use a star wire topology, that is all cabling is wired from the Home Distribution Hub in the garage to the outlet plate or device as an individual feed without joints, tap offs or splitting.

All telecommunications cabling must be installed by a licensed contractor to TS009, AS3000, relevant Australian Standards and ACIF guidelines – otherwise your home may

not be compliant. This document details the correct separations and installation requirements.

Warning! All customer cabling work **MUST** be performed by a registered cabler. If a cabler is registered, they will have a card which proves that they can legally perform cabling work.

The cabling work must comply with the Wiring Rules, which detail the minimum requirements for cabling installations to ensure that network integrity and the health and safety of end-users, other cablers and carrier personnel is protected.

The cabling is required to have adequately separation or segregation from electrical cabling to avoid creating a dangerous situation.

Failure to use a registered telecommunications cabler may result in fines of up to \$13,200.

4.1 Standards

This document is the technical specification and is to be provided to your Builder/Telecommunications Contractor. If you are unsure of any of the information contained herein, please don't hesitate to contact us to ensure the correct standards are followed – we are more than happy to provide you with the right advice and support so that you get it right the first time.

4.2 Smart Wiring

“Smart wiring” is a term commonly used to describe home wiring that may include, but is not limited to, one or more of the following:

- structured telephone, data (Internet) and TV cabling (such as described in this document)
- home security — intruder detection, back-to-base monitoring or CCTV (Closed Circuit Television)
- home theatre and/or in-house audio/video distribution
- home automation — “intelligent” lighting, automatic/remote control of electrical appliances, HVAC (Heating, Ventilation and Air Conditioning), lawn/garden irrigation, etc.
- paging/intercom, which may include music distribution or CCTV.

Such systems may be wired separately by different installers or may be included in a total wiring package offered by a SmartWired builder or contractor. However, this document only describes the telephone, data and TV cabling system.

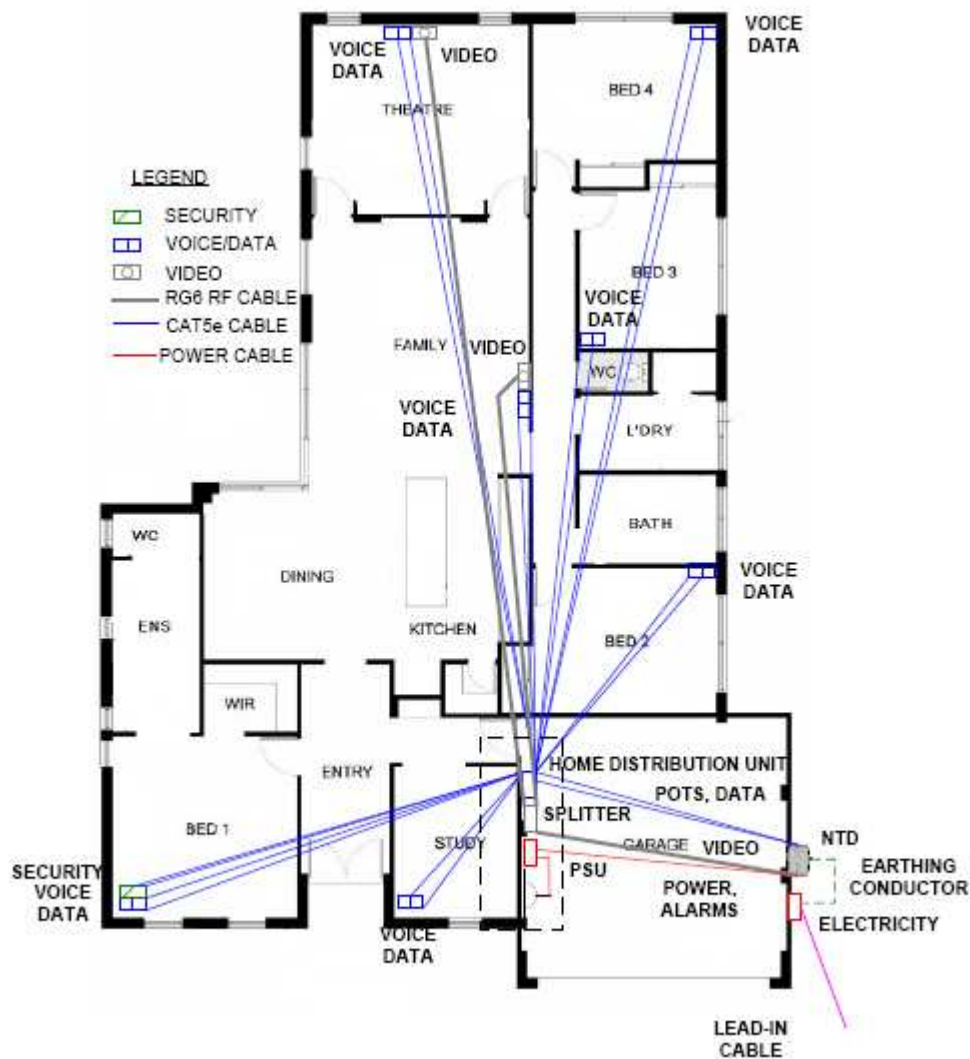

Figure 1 - Sample Home Wiring

4.3 Data/telephone outlets

In Smart Wired™ homes there is no difference between a telephone point and a data point, so consider all points as being cable of both telephone and data. A data/telephone outlet is terminated with a RJ45 socket.

For data and telephone points UTP Cat5e cable needs to be used from the HDU. The signal can transmit for up to 100m from the NTD. Cat6 cable can be used which will provide for larger bandwidth needs in the future, however there is additional cost.

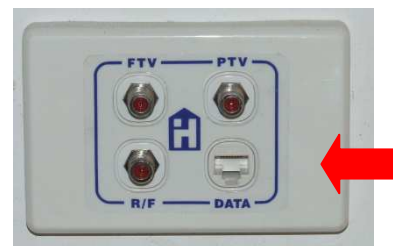

Figure 2 - Data/Telephone Outlet

Method of Installation

Two methods of cabling are possible. One method is to locate future data switches/routers in a study or computer room where tie cables need to be run from the HDU to the study with all outlets star wired from the HDU to the final outlets terminating in a RJ45 outlet. The recommended method is to locate the data switch/router in the HDU with star wiring to all outlets terminating in a RJ45 outlet.

At pre-plaster stage, your Builder/Telecommunications Contractor must provide Cat5e cable from each telephone point in the home to meet (star wired) at the HDU. A Telephone socket (RJ45) socket must also be installed in the HDU configured in a 'mode 3' format for the security monitoring device.

4.4 RF Outlets (Television)

The RF Outlets supply both the free to air and pay television signal. Their terminations must be F type female.

Coaxial cable (RG6 Quad Shield) cable star wired (not loop or tap and drop) needs to run from each TV outlet location to the HDU. The maximum length of cable between the HDU and the RF outlet is 23m. This can be extended to 32m if an amplifier or RJ11 cable is used between the HDU and the RF outlet.

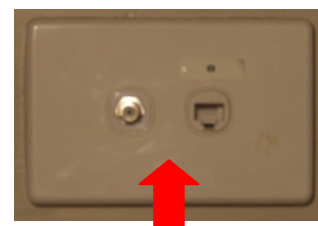

Figure 3 - RF Outlet

Method of Installation

All splitters/amplifiers need to be located within the HDU. The presentation is via one F type connector to be provided by the Builder or Telecommunications Contractor. The typical RF output level from the network is 75dB μ V \pm 2dB. A high quality amplifier (capable of handling 60+ channels) may be required if more than 4 outlets are required.

4.5 Data with every RF Point

To take advantage of network capable Digital Video Recorders, Intelligent PayTV Set Top Boxes (e.g. FoxTel IQ) and any future Video on Demand or IPTV services, it is recommended to install an RJ45 socket (data/telephone) wherever an RF point is located.

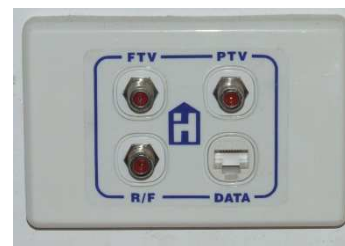

4.6 Wireless Access Point

A wireless access point can be installed to provide a wireless local area network to the home. Consider the location of the data/telephone outlet for the access point. Have it in an open area on a high point to optimise data speed and minimize attenuation from walls.

4.7 Security

If a monitored security alarm is to be installed in the building, a mode 3 connection is to be installed to give the alarm priority access to the telephone line. The alarm panel should be connected between the NTD and HDU in regards to the first telephone line.

While often used as generic descriptions, “Smart Wiring” and “SmartWire” are trademarks of the Copper Development Centre. The SmartWired web site is www.smartwiredhouse.com.au.

5.0 Home Distribution Unit

The HDU is the central hub of the smart wiring network of the home. Typically it is a steel cabinet installed in the garage with a lock that houses all of the passive and active equipment. All services enter and exit this cabinet. This allows for total flexibility to the home owner in the future. It must be of a minimum size of 405mm wide (to fit between studs), 600mm high and 112mm deep. Typically the bottom of the cabinet is mounted 1200mm above finished floor level and is recessed into the wall with bottom and top ventilation into the cavity wall.

It needs to be large enough to can cater for any active device such as alarm panels, television amplifiers, data switches and 240Vac power outlets and have enough room for cable looms, IDC blocks, splitters and couplers.

It is the responsibility of the Builder/Telecommunications Contractor to provide the smart wiring and Home Distribution Unit.

5.1 Location of HDU

The HDU is typically installed inside the house in an accessible location. Choose a dry, well ventilated area at least 1m away from high energy rating electrical equipment to prevent electromagnetic interference. This can include electrical switchboards, supply meters, fluorescent lights, electrical transformers, generators, ducted vacuum motors, and power tools in operation, air conditioning units, refrigerators or freezers. The bottom of the HDU must be mounted at a height above floor level between 350mm and 1700mm.

5.2 Choices of HDU

There are a few different types of HDUs to choose from. A basic HDU is installed by mounting the equipment on a wall and having no enclosure. Be sure to have adequate ventilation for the components and supply a 10 Amp double GPO for the Power supply and optical receiver.

Alternatively a more professional installation using a Hills Home Hub unit can via you lots of flexibility and also can be optioned up with a security system and audio reticulation.



6.0 Planning out your Home Wiring

Use this chart to calculate what TV, internet, data, telephone and other services you need in the rooms of your home.

Rooms	Simply ✓ the appropriate box to calculate the points required				
	Home Hub	TV	Internet	Telephone	GPO
Lounge					
Family Room					
Master Bedroom					
Bed 2					
Bed 3					
Bed 4					
Study					
Kitchen					
Dining					
Garage					

